

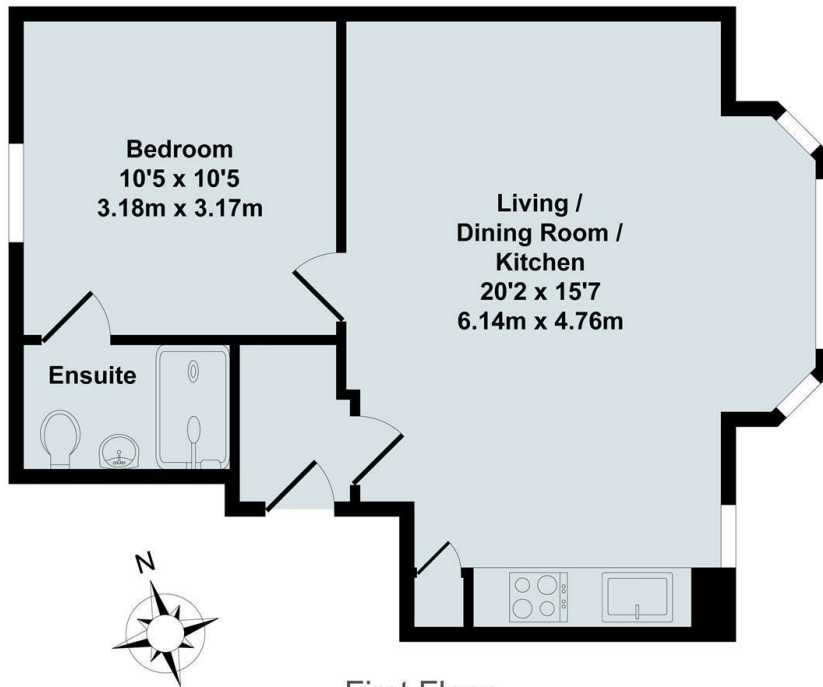

## Flat 4, 122 Marlborough Road, Oxford, OX1 4FR

£1,450 PCM - 25th April 2026.

- One bedroom
- Electric heating
- NO PARKING
- Mains electricity and water
- Ensuite shower room
- First floor
- EPC rating C
- Part furnished
- Communal gardens
- Council tax band C



First Floor

Total Approx. Floor Area 434 Sq.Ft. (40.30 Sq.M.)  
 All items illustrated on this plan are included in the "Total Approx Floor Area"

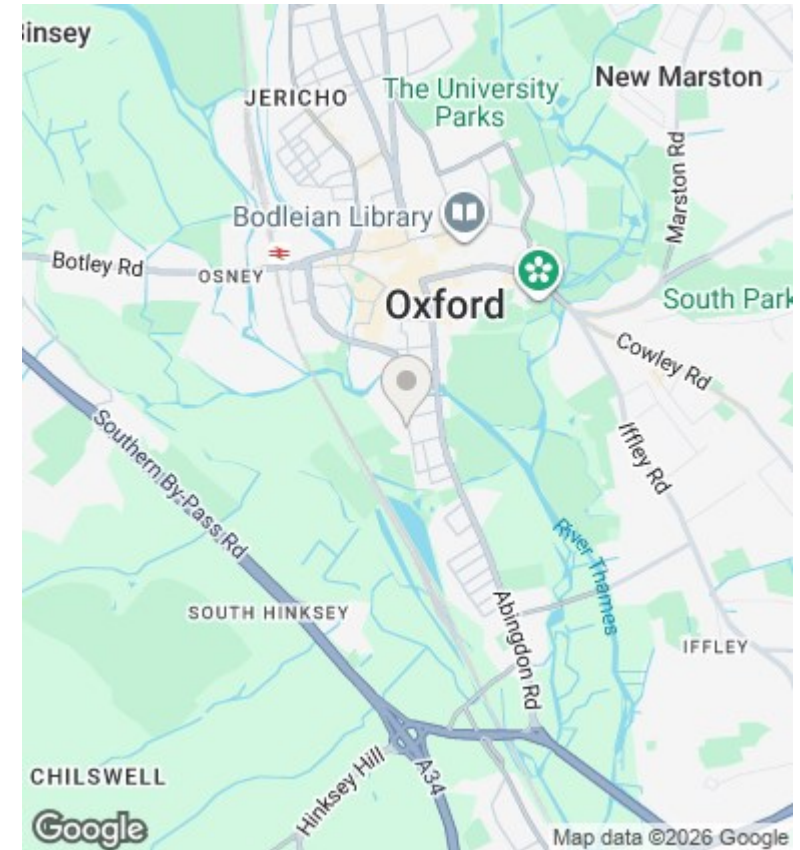

## Directions

## Viewings

Viewings by arrangement only. Call 01865 515900 to make an appointment.

## Council Tax Band

C

## EPC Rating:

C

Energy Efficiency Rating		Current	Potential
<i>Very energy efficient - lower running costs</i>			
(92 plus) <b>A</b>			
(81-91) <b>B</b>			
(69-80) <b>C</b>		79	82
(55-68) <b>D</b>			
(39-54) <b>E</b>			
(21-38) <b>F</b>			
(1-20) <b>G</b>			
<i>Not energy efficient - higher running costs</i>			
<b>England &amp; Wales</b>		EU Directive 2002/91/EC	